

CERTIFICATE OF LOCATION OF GOVERNMENT CORNER

North Quarter Corner of Section 3, Township 105, Range 41, 5th P.M.

STATE OF MINNESOTA, County of MURRAY

At the corner location shown on the sketch:

- On _____ found a _____
DATE
- left monument as found, lowered monument, removed monument (explain)
- On 9-22-77 placed a 1/2" x 14" Iron Pipe, Down 0.2'
DATE

SKETCH OF REFERENCE TIES

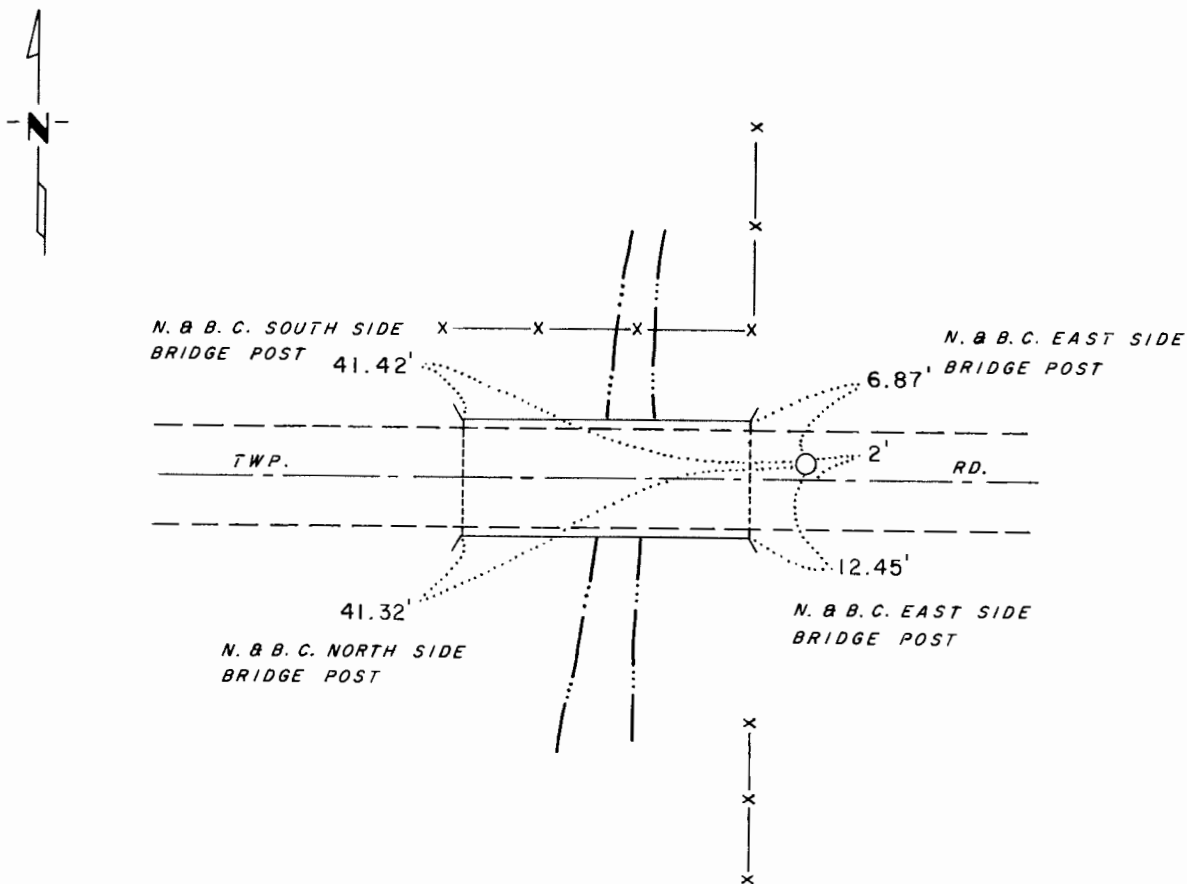

Statement of evidence relative to this corner location is on back of page.

I hereby certify that this document and the data contained herein was prepared by me or under my direct supervision.

Sam H. Stevenson 7-3-78
SIGNATURE DATE

Registration No. 12684

- Land Surveyor, Professional Engineer
- County Surveyor, County Engineer

OFFICE OF THE REGISTER OF DEEDS

County of _____

I hereby certify that this document was filed in the Reg. of Deeds office at _____ .M. on the _____ day of _____ A.D., 19 _____

Register of Deeds _____

By _____, Deputy

DOCUMENT NO. _____

Statement of Evidence:

North Quarter Corner Section 3, T 105 R 41

Murray County

This corner was originally established by the U.S. General Land Office survey in 1861. The government notes show corner marked with a wood post set in mound of earth with pits and trench dug around the mound.

In May, 1977 the DNR Bureau of Engineering contacted the Murray County Offices of the Recorder, Auditor and Engineer for corner information.

The only information found was a survey of Section 34, T 106 R 41 by J. W. Woolstencroft in 1898 in the section book kept in the County Engineer's office. He states this corner was a stake 6' east of a bridge on the north side of grade. He measured 40.04 chains (2642.64) to the section corners both east and west.

The DNR looked for this corner in May and July, 1977. The location of this corner falls just to the east of a bridge, which has been rebuilt since 1898. We believe the stake set by Woolstencroft would have been knocked out at this time. So we established this corner by lost position, midway and on line between section corners. Our distances to the section corners was 2645.43' and approximately 20'+ east of the center of the creek, in line with a fence north, and 2' north of the centerline road. This position fits both the 1898 survey and the original survey. A 1/2" x 14" iron pipe was set to mark this corner.

SS

164273

State of Minnesota, }
County of Murray, } ss.

I hereby certify that the within instrument
was filed in this office for record on the

7th day of August A.D. 19 81,

at 8:30 o'clock A.M., and was duly re-

corded as Microfilm Document No. 164273

Willard W. Ohme

County Recorder